



CONFERENCE & EVENTS

ST BRIDE

THE ST BRIDE FOUNDATION CONFERENCE & EVENTS



There is something special about a venue steeped in history – a centre that lies at the heart of the City of London created for the community. The St Bride Foundation is such a place. We have ten rooms of various sizes which suit a variety of events.

Large – Events for 1-200 people

Bridewell Hall	2
Bridewell Theatre	3

Medium – Events for 1-80 people

Salisbury Room	4
Passmore Edwards Room	5
Farringdon Room	6
Layton Room	7
Blackfriars Room	9

Small – Events for 1-50 people

Caxton Room	10
Photographic Studio	11
Theatre Bar	12
Ludgate Room	13

Bridewell Hall



ST BRIDE FOUNDATION CONFERENCE & EVENTS

Our largest hall, an elegant high-ceilinged space with large windows, lends itself just as easily to conferences, lectures and AGMs as to lavish parties and wedding receptions.

For events over 100 participants it is recommended that you book the adjoining Farringdon room for registration and catering.

- Telephone
- Speaker
- Powerpoints
- Disabled access

Capacity

- a}** Theatre style 150 (max)
- b}** U Shaped 45 (max)
- c}** Boardroom 50 (max)
- d}** Classroom 80 (max)
- e}** Formal Dinner 100 (max)
- f}** Standing 200 (max)

Communications

- Wireless broadband available on request

Lighting

- Natural daylight, blinds for full black out, fluorescent tubes and spots

Access

- Disabled access via St Bride's Passage from Salisbury Court

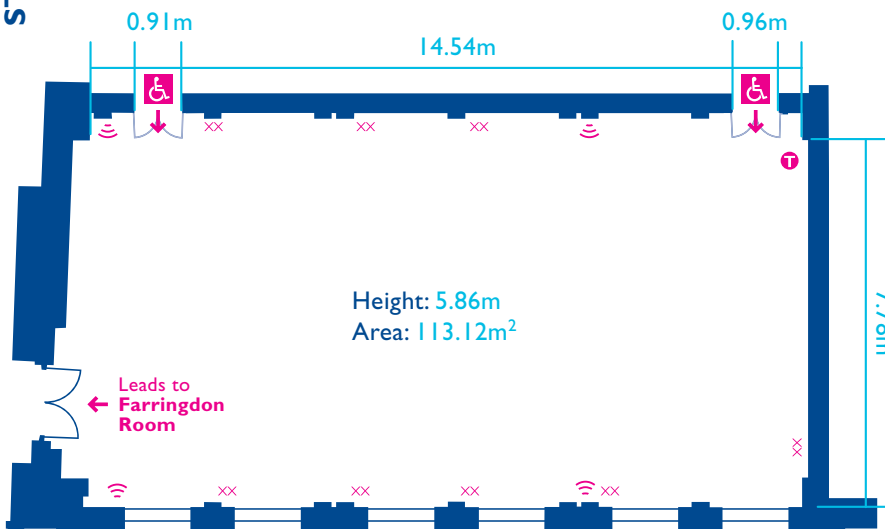

ST BRIDE FOUNDATION
 Bride Lane Fleet Street
 London EC4Y 8EQ





T 020 7353 3331 F 020 7353 1547
 E info@stbridefoundation.org
www.stbridefoundation.org

Bridewell Theatre



ST BRIDE FOUNDATION CONFERENCE & EVENTS

A fully equipped presentation and lecture theatre with raked seating and excellent sight lines, in the most versatile theatre in London. Or if parties are more your thing, the seating can be removed to create a large space for dancing, a band, cabaret, buffet etc. The theatre bar may also be hired as an additional social space.

-  Telephone
-  Speaker
-  Powerpoints
-  Disabled access

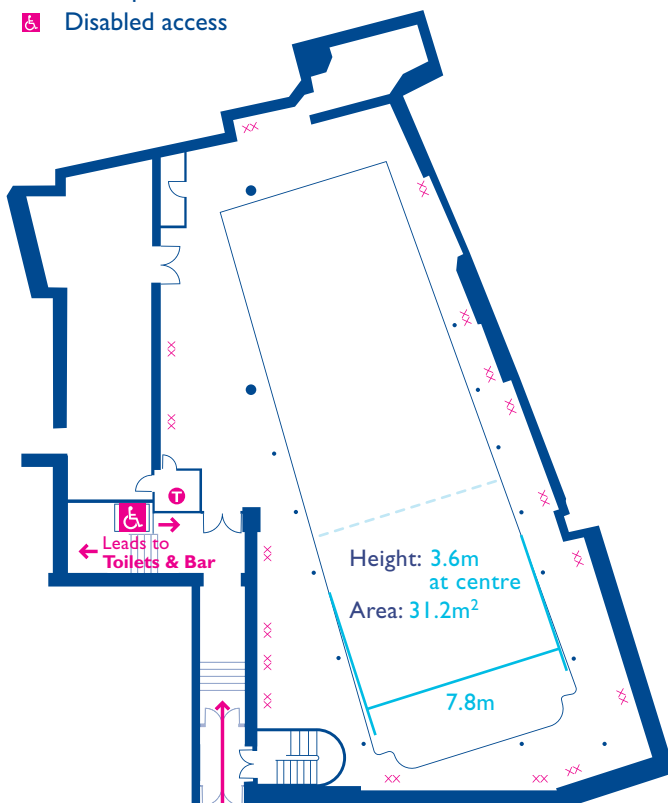

Capacity

- a} Theatre style 134 (max)
- b} Standing 200 (max)

Communications

- Wireless broadband available on request

Telephone

- Available in box office only

Lighting

- Natural daylight, blinds for full black out, full lighting rig available

Access

- Disabled access via Bride Lane



ST BRIDE FOUNDATION
Bride Lane Fleet Street
London EC4Y 8EQ

T 020 7353 3331 F 020 7353 1547
E info@stbridefoundation.org
www.stbridefoundation.org

Salisbury Room



ST BRIDE FOUNDATION CONFERENCE & EVENTS

Enjoy boardroom meetings, presentations, private receptions or press launches in perhaps the most sumptuous room the Foundation offers. The Salisbury room is traditionally decorated with a working Late Victorian fireplace and bespoke walnut table that will bring a touch of elegance to any event you choose to hold.

For day events we recommend that you also book the adjacent Caxton Room for refreshments and lunch.

- ⓧ Telephone
- Ⓜ Speaker
- xx Powerpoints
- ♿ Disabled access

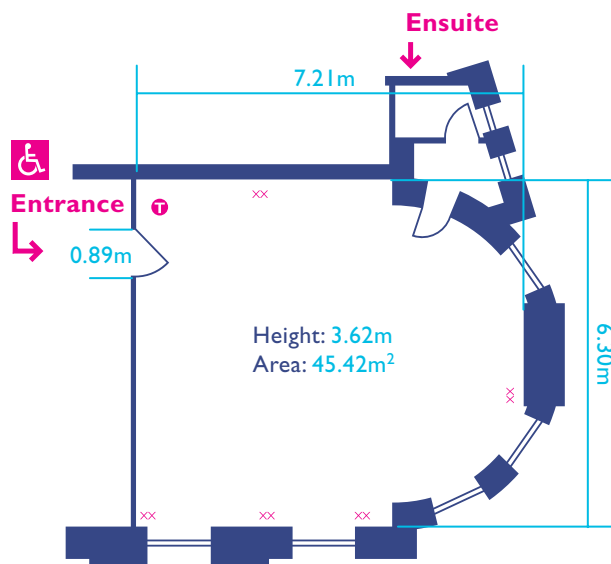

Capacity

- a}** Theatre style 50 (max)
- b}** U Shaped 18 (max)
- c}** Boardroom 25 (max)
- d}** Classroom 15 (max)
- e}** Standing 60 (max)

Communications

- Wireless broadband available on request

Lighting

- Natural daylight, blinds, curtains and dimmable lights

Access

- Disabled access via St Bride's Passage from Salisbury Court



ST BRIDE FOUNDATION
 Bride Lane Fleet Street
 London EC4Y 8EQ

T 020 7353 3331 F 020 7353 1547
 E info@stbridefoundation.org
www.stbridefoundation.org

Passmore Edwards Room



ST BRIDE FOUNDATION CONFERENCE & EVENTS

Escape the bedlam of the City in the tranquility of St Bride Library's old Reading room. On the top floor, this room offers inspirational views of St Bride's church and provides a provocative room for small training groups, board or committee meetings.

- Telephone
- Speaker
- Powerpoints
- Disabled access

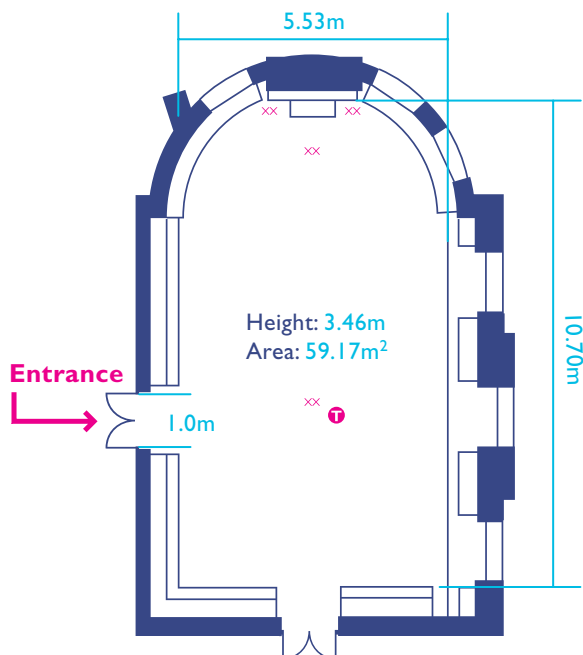

Capacity

- a} U Shaped 25 (max)
- b} Boardroom 30 (max)
- c} Standing 60 (max)

Communications

- Wireless broadband available on request

Lighting

- Natural daylight

Access

- No disabled access



ST BRIDE FOUNDATION
 Bride Lane Fleet Street
 London EC4Y 8EQ

T 020 7353 3331 F 020 7353 1547
 E info@stbridefoundation.org
www.stbridefoundation.org

Farringdon Room



ST BRIDE FOUNDATION CONFERENCE & EVENTS

Perfect for training days, workshops and small reception parties. This light and stylish room works well for most events. When booked in conjunction with the Bridewell Hall, this space is ideal for registration and catering.

- T Telephone
-)) Speaker
- xx Powerpoints
- ♿ Disabled access

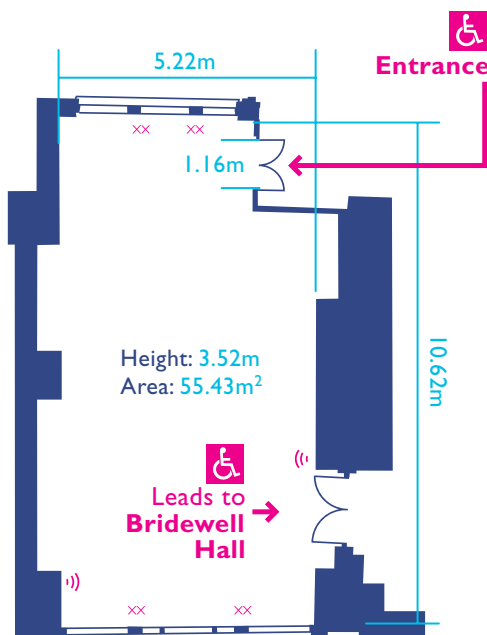

Capacity

- a} Theatre style 60 (max)
- b} U Shaped 25 (max)
- c} Boardroom 30 (max)
- d} Classroom 40 (max)
- e} Standing 80 (max)

Communications

- Wireless broadband available on request

Lighting

- Natural daylight, blinds, exhibition lighting

Access

- Disabled access via St Bride's Passage from Salisbury Court



ST BRIDE FOUNDATION

Bride Lane Fleet Street
London EC4Y 8EQ

T 020 7353 3331 F 020 7353 1547

E info@stbridefoundation.org

www.stbridefoundation.org

Layton Room



ST BRIDE FOUNDATION CONFERENCE & EVENTS

A bright room filled with natural light provides an effective training facility or workshop space for up to 40 people.

- T Telephone
-)) Speaker
- xx Powerpoints
- ♿ Disabled access

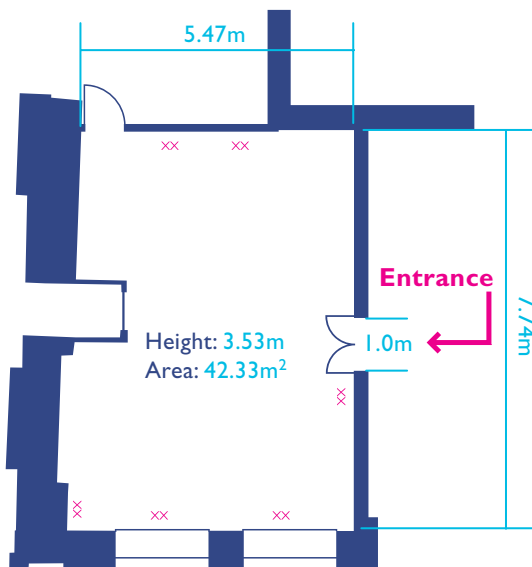

Capacity

- a} Theatre style 40 (max)
- b} U Shaped 25 (max)
- c} Boardroom 30 (max)
- d} Classroom 20 (max)
- e} Standing 50 (max)

Communications

- Wireless broadband available on request

Lighting

- Natural daylight, lights on dimmers

Access

- No disabled access



ST BRIDE FOUNDATION
Bride Lane Fleet Street
London EC4Y 8EQ

T 020 7353 3331 F 020 7353 1547
E info@stbridefoundation.org
www.stbridefoundation.org

Blackfriars Room



ST BRIDE FOUNDATION CONFERENCE & EVENTS

Filled with natural daylight, this is a very versatile room on the top floor equally suited to lectures and workshops as to Yoga and Pilates classes, or rehearsals.

- Telephone
- Speaker
- Powerpoints
- Disabled access

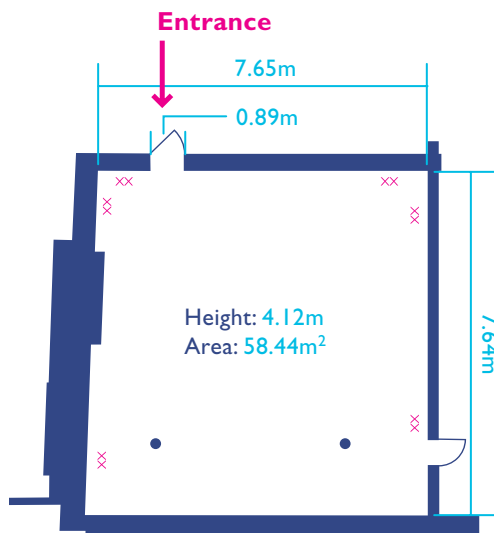

Capacity

- a} Theatre style 60 (max)
- b} U Shaped 16 (max)
- c} Boardroom 30 (max)
- d} Classroom 25 (max)
- e} Standing 80 (max)

Communications

- Wireless broadband available on request

Lighting

- Natural daylight, lighting on dimmers & blinds

Access

- No disabled access



ST BRIDE FOUNDATION
 Bride Lane Fleet Street
 London EC4Y 8EQ

T 020 7353 3331 F 020 7353 1547
 E info@stbridefoundation.org
www.stbridefoundation.org

Caxton Room



ST BRIDE FOUNDATION CONFERENCE & EVENTS

This tranquil space is ideal for meetings of up to 8 people. When booked in conjunction with the Salisbury room it works well as a breakout space or for catering.

Capacity

- a} Theatre style 10 (max)
- b} Boardroom 8 (max)
- c} Standing 15 (max)

Communications

- Wireless broadband available on request

Lighting

- Natural daylight

Access

- Disabled access via St Bride's Passage from Salisbury Court

- Telephone
- Speaker
- Powerpoints
- Disabled access

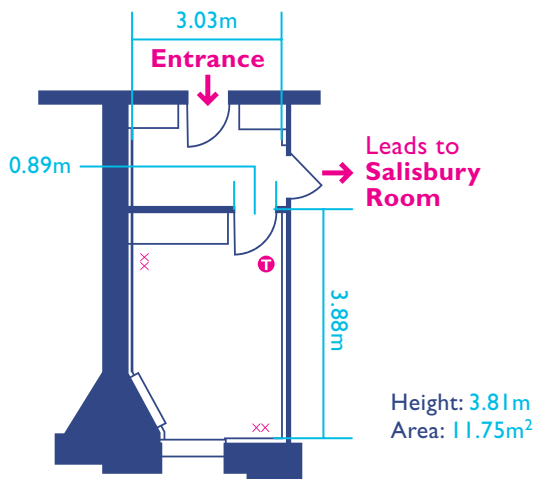

ST BRIDE FOUNDATION

Bride Lane Fleet Street
London EC4Y 8EQ

T 020 7353 3331 F 020 7353 1547
E info@stbridefoundation.org
www.stbridefoundation.org

Photographic Studio



ST BRIDE FOUNDATION CONFERENCE & EVENTS

Not only the perfect location for photography and art classes, our community rates make it very popular with Yoga, Pilates and rehearsal groups.

- Telephone
- Speaker
- Powerpoints
- Disabled access

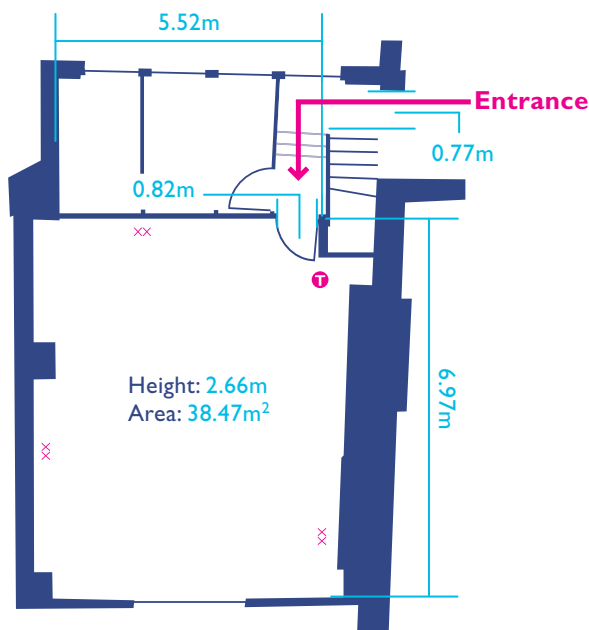

Capacity

- a} Theatre style 25 (max)
- b} U Shaped 15 (max)
- c} Boardroom 20 (max)
- d} Standing 30 (max)

Communications

- Wireless broadband available on request

Lighting

- Natural daylight plus skylight, complete blackout possible

Access

- No disabled access



ST BRIDE FOUNDATION

Bride Lane Fleet Street
London EC4Y 8EQ

T 020 7353 3331 F 020 7353 1547

E info@stbridefoundation.org

www.stbridefoundation.org

Theatre Bar



ST BRIDE FOUNDATION CONFERENCE & EVENTS

A laundry room in Victorian times, the Bridewell Bar exudes warmth and character that makes it perfect for private parties.

Capacity

a} Standing 50 (max)

Telephone

- Available – details on request

Access

- Disabled access via Bride Lane

- Ⓣ Telephone
- Ⓜ Speaker
- xx Powerpoints
- ♿ Disabled access

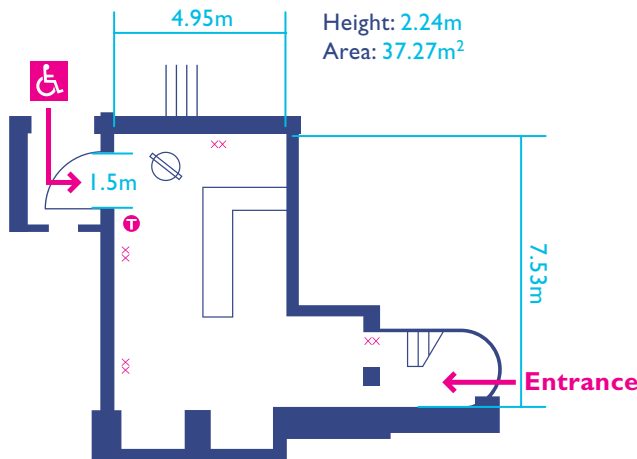

ST BRIDE FOUNDATION
 Bride Lane Fleet Street
 London EC4Y 8EQ

T 020 7353 3331 F 020 7353 1547
 E info@stbridefoundation.org
 www.stbridefoundation.org

Ludgate Room



ST BRIDE FOUNDATION CONFERENCE & EVENTS

This light and quiet room makes a most comfortable room for your smaller meetings.

Capacity

a} Boardroom style 8 (max)

Communications

- Wireless broadband available on request

Lighting

- Natural daylight

Access

- No disabled access

xx Powerpoints

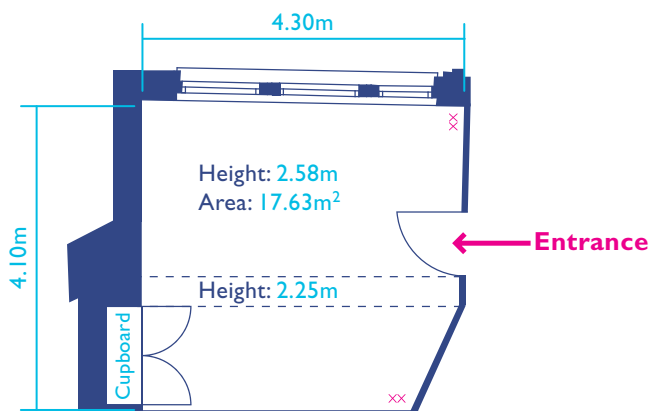

ST BRIDE FOUNDATION

Bride Lane Fleet Street
London EC4Y 8EQ

T 020 7353 3331 F 020 7353 1547

E info@stbridefoundation.org

www.stbridefoundation.org



Commitment



Client charter

The St Bride Foundation team promises to:

- Be flexible and accommodate clients' requirements as far as possible.
- Respond to clients' requests in person, by telephone, email or other correspondence within 24 hours.
- Ensure all clients receive a professional, high quality and enjoyable experience at the Foundation.
- Provide access to all through its Diversity Policy.
- Work with all staff and partners of choice to continually improve service and commitment to clients.
- Seek feedback from clients to help shape services and responsiveness in the future.
- Provide effective induction and training of all staff through the Foundation's training programme.
- Supervise the public and building in a manner that ensures the enjoyment of the facilities within the restrictions imposed by health and safety regulations.
- Our Environmental Policy is to promote the use of sustainable resources and discourage practises that are wasteful and damaging to the environment.

Accessibility



Opening hours 8:30am - 9:45pm

Access to all

The St Bride Foundation encourages access to all. Our clients come from a diverse range of backgrounds and include corporations, charitable institutions and private individuals. Due to the sustained and greatly appreciated business of our corporate clients, the St Bride Foundation is able to offer registered charities a significant discount on room hire. Last year alone we subsidised charitable groups to the sum of around £300,000.

Diversity Statement

The Foundation promises to:

- Produce a wide range of promotional material and media that advise and inform customers and all members of the community of the services and facilities available.
- Offer a customer friendly booking and payment system through a variety of methods.
- Promote accessibility through keen pricing and significant discounts for charitable groups.
- Develop the physical accessibility of the Foundation where possible.
- Seek customer views and comments on the services provided through an open and responsive forum.

Reach the St Bride Foundation

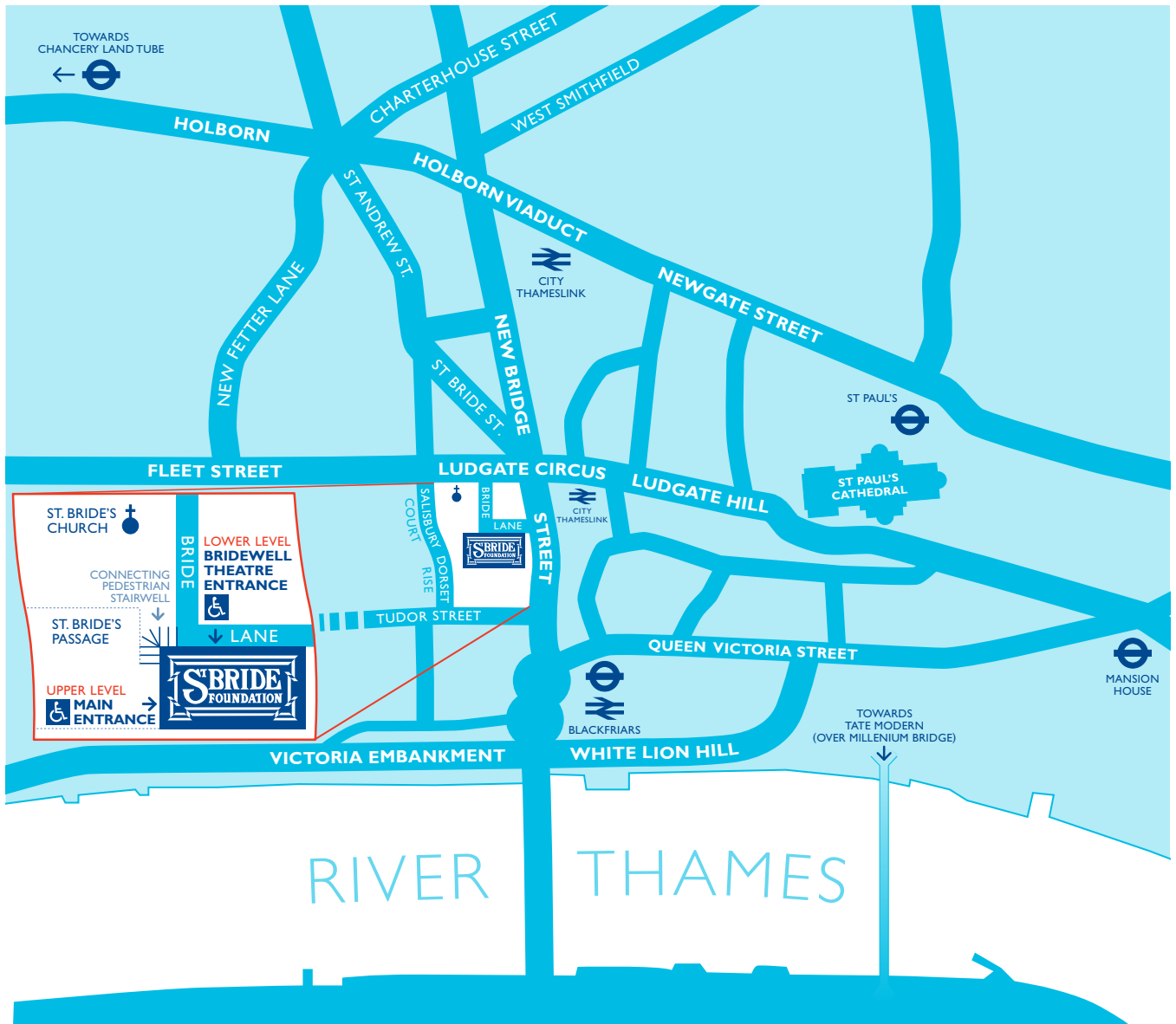

By Tube

Blackfriars District & Circle line (3 mins to Foundation)
St Paul's Central line (7 mins to Foundation)

By Bus

Fleet Street 4, 11, 15, 23, 26, 76
New Bridge Street 45, 63, 172

By Rail

City Thameslink (2 minutes to Foundation)



ST BRIDE FOUNDATION

Bride Lane Fleet Street
London EC4Y 8EQ

T 020 7353 3331 F 020 7353 1547

E info@stbridefoundation.org
www.stbridefoundation.org

Car

Nearest NCP Carpark:

Hillgate House, Limeburner Lane, London EC4M 7HY

Open 24 hours a day.

From Ludgate Hill, turn left into Old Bailey,
then left into Limeburner Lane



Disabled access to the Foundation via St Bride's Passage
entrance from Salisbury Court.

Please contact us for more precise directions.

Brochure by the Knifedge Creative Network

Design: Lucy Boarder, Marcus Taylor & Timothy Bird

Photography: Amber McDonald (Johnson's Dictionary – Malcolm Hadley)

Farringdon Room Photograph: Tessa Newmark